

SOLAR BRAZED PLATE HEAT EXCHANGERS

SOL-Line

Single Wall and Double Wall Copper Brazed Plate Heat Exchangers for Solar Domestic Hot Water Systems

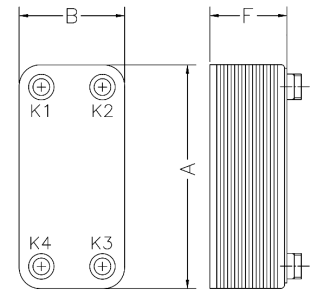

RECOMMENDED PORT DESIGNATIONS
 (K1) HOT FLUID IN (K3) COLD FLUID IN
 (K4) HOT FLUID OUT (K2) COLD FLUID OUT

Model (Single Wall / Double Wall)	Nominal BTU/h*	A (in)	B (in)	F (in)	Standard Connection (NPT)
SOL-030 / SOL-030DW	Up to 30,000	8	3	1.4	3/4"
SOL-050 / SOL-050DW	Up to 50,000	8	3	2.3	3/4"
SOL-075 / SOL-075DW	Up to 75,000	8	3	3.0	3/4"
SOL-100 / SOL-100DW	Up to 100,000	8	3	4.0	3/4"
SOL-125 / SOL-125DW	Up to 125,000	8	3	5.0	3/4"

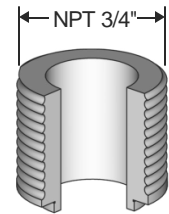

* Nominal Values are based on 120°F temperature difference between incoming heating and heated water.
 Hot Side: 40% Propylene Glycol, Cold Side: Domestic Water

Materials Of Construction

Heating Plates	ANSI 316 – Single Wall or Double Wall
Pressure Plates/ Connections	Stainless Steel
Brazing Material	Copper

Max Flow | Design Parameters

Max Flow (USGPM)	Design Pressure (PSI)	Design Temperature (F)	Test Pressure (PSI)
29	435	302	624

- Dimensions subject to change without notice.
- Contact AIC for certified drawings
- This product is UL listed
- Not suited for ammonia, steam, and highly chlorinated water
- Not suited for pool/spa applications
- Not suited for pulsating pressures

Double Wall Advantage

AIC Double Wall Brazed Plate Heat Exchangers consist of two stainless steel plates (instead of one) to prevent cross contamination of fluids in the event of an internal leak. The air gap between the two plates allows the leak to be vented to the atmosphere, enabling visual detection.

